

CHAGNON

☎ 800 565-1723

[🏠](#) > [CHAGNON](#) > [CABLE HOIST ROLL-OFF SYSTEMS](#) > > DRC-AF 60,000 lb. series

DRC-AF 60,000 LB. SERIES

DESCRIPTION

Durable, reliable and safe. One of the best roll-off systems in the industry!

With 60,000 lbs. of total capacity and a 1 in. cable (25.4 mm - 6X26 – 103,400 lb.), our DRC-AF 60 000 system is ideal for heavy daily use in most commercial, municipal and industrial applications.

It is designed to facilitate equipment maintenance as well as operators and maintenance engineers' work . Chagnon roll-offs' build quality exceeds the standards of the industry (ANSI Z245.1, CSA W47.1, FMWS/MMSSS, WASTEC, ect.)

KEY FEATURES AND ADVANTAGES

IMPROVED HEAVY DUTY FRAME HINGE OFFERS BETTER STABILITY.

SAFE AND LIGHT REMOVABLE NOSE STOPPERS WITH TUBING SLEEVES (2" X 4" X 3/8").

1" HOIST CABLE (6 X 26 - 106,000 LB. CAPACITY) WITH D-RING FOR GREATER VERSATILITY AND RESISTANCE (OPTIONAL BEAR CLAW).

EASY ACCESS TO CYLINDERS FOR QUICK MAINTENANCE.

40 GALLON HYDRAULIC RESERVOIR WITH INTEGRATED 10 MICRON SUBMERGED OIL FILTER AND OIL LEVEL AND TEMPERATURE GAUGES.

IN-CAB HEAVY DUTY ERGONOMIC AIR OVER HYDRAULIC CONTROLS.

SALAMI 40 GPM MANUAL CONTROLS FOR HYDRAULIC OPERATIONS (OUTSIDE CAB).

QUICK CHANGE SHAVERS: REPLACE WITHOUT UNMOUNTING CYLINDERS.

SLIDING CARRIAGE ON NYLATRON WEAR PADS.

GREASABLE 4" SIDE ROLLERS (21/2" SHAFT) WITH ALUMINIUM BRONZE BUSHING.

BOLTED GROUND ROLLER CAN BE REPLACED IN 10 MINUTES.

FMWSS/CMVSS APPROVED LED LIGHTS.

TECH SHEET

GENERAL SPECIFICATIONS, DRC-AF SERIES - 60, 000 LBS CAPACITY	
Models	DRC-6025-AF
Length:	25'
Hoist Frame:	12" x 4" x 3/8" tube (sub frame 4" x 3" x 1/4")
Top rail wear strip:	PL 5/16" x 3" x 8' . QT-100
Hinges:	6" wide x 4" diam. - with 2 1/2" shaft (opt. 3") mechanical tubing
Front stopper:	1 1/2" thick 44W
Winch cable:	7/8" (22.2 mm) 82,000 lb. capacity (option.: 90,000lb. turbo pressed)
Hook/bushings:	Hook - 9" Crosby/Swivel/Gunnebo
Wear pads:	Nylatron 5/8" x 2 1/4" x 15"
Rear roller:	6 5/8" diam. x 20" long
Side rollers:	4" width by 4" diam. with 2 1/2" shaft, and lubrication point. Aluminum bronze bushing and support. (option.: 5" diam.)
Winch sheaves:	(1) 12" sheave with 2" shaft - (3) 8" sheave with 2" shaft.
CYLINDERS	
Side cylinders:	7 1/4" bore with 3 1/2" rod - 94" stroke (2x)
Winch cylinders:	7 1/4" bore with 3 1/2" rod - 89" stroke
PAINT	
Colour :	Black, sandblasted, epoxy ester primed with 2 coats of urethane alkyd.
CONTROLS	
Control unit inside cab.	
Internal controls:	Air
External controls:	Manual
HYDRAULIC SYSTEM	
Tank:	40 gal. (150 litres)
Return filter:	10 Microns, installed in the tank
PTO:	Direct on manual transmission, air clutch
SUGGESTED EQUIPMENT (optional)	
Pump / P.T.O.	36 GPM at 1200 RPM (gear) - option.: 38 GPM (vane)
Pump type:	RPM - directly to PTO for manual transmission (option.: front mount)
Hydraulic distribution:	VD12 double action
STANDARD ACCESSORIES AND EQUIPMENT	
Safety bracket:	Steel, street side
Back-up alarm:	Back-up alarm activated when vehicle reverses
Fenders:	Galvanized steel
Brake protectors:	Steel
ELECTRICAL SYSTEM	
Compliance:	FMWSS/CMVSS approved L.E.D.
Wiring:	100% waterproof
Lighting:	2 back-up lights 4 stop lights 1 licence plate light 3 marker lights at end of rails with side lights 1 Tailgate Light

SPECIFICATIONS

The system must be compliant with the ANSI Z-245.60 2008 safety standard, all safety labels must be in the working language, and the system must be compatible with U-type cable containers. It shall be manufactured with the highest quality standards, construction plans must be approved by an engineer member of an accredited board, assembled and welded in accordance with the Canadian Welding Bureau (CWB) requirements.

Lifting system:

- 60,000 lbs lifting capacity
- Available frame lengths: 25 ft. or custom, (Specifications for 25 ft., AC required 207 to 210)
- Frame lifting stingers: 4" x 12" x 3/8" tubing (no subframe required)
- Mobile carrier is robust and bolted for easy maintenance, and the carrier includes Nylatron wear skids: 5/8" x 2 1/4" x 15"
- 1" (25.4 mm) hoist cable 6 x 26 of 106,000 lbs capacity with a "D-loop" bushing for increased flexibility and strength
- Winch sheaves:
 - 12" Sheave with 2" shaft
 - 8" Sheave with 2" shaft
- Side rollers with 4" mechanical tubing, 2 1/2" shaft, aluminum bronze bushing with lubrication point and welded supports (at least 4 on each side), addition of 5/16" x 4" flat bars between rollers to secure container movement
- Welded wear plates on rear part of stingers: 5/16" x 3" x 8"
- Ground roller between stingers: 6" x 20" HD. Bolted for easy maintenance
- Fixed front stopper (1 1/2") approved by an engineer and welded in compliance with the CBW requirements
- Lightweight and safely removable stopper inserted into stingers for 20' or 22' containers. Inserts must be seal welded in order to avoid water infiltration in the stingers' core centre.
- 2" hinge shaft with 6" mechanical tubing hinges
- Galvanized corrugated steel fenders for tandem rear axles
- Steel safety tips that supports the frame during maintenance on the driver's side

Hydraulic System:

- 55 gal. tank (150 lbs.)
- 10 micron filter installed in the tank with oil level and temperature indicator.
- Distribution by double-action VD12 hydraulic valve
- Lifting Cylinder (Side) 5" (for 22') and 6 1/2" (for 24' and 26')
- Winch Cylinder: 7 1/2"
- Control box inside the cab provides an ergonomic location and pneumatic controls on the hydraulic system
- External manual hydraulic controls with a 36 GPM valve

Electrical System:

- Electrical system approved by FMVSS / CMVSS L.E.D.
- All wiring is 100% waterproof
- Lighting arrangement on the bumper:
 - 2 reversing lights activated during reverse
 - 4 stop lights
 - 1 plate light
 - 3 stinger lights with MTC compliant side lights
 - 1 tailgate rear light

Safety:

- All lights are LED
- Robust safety holders
- Fastener belt included in each container

Finish:

- Based on the selected options

Warranty:

- Structural manufacturing defect: 3 years
- Pumps, cylinders, or other hydraulic and electrical components: 2 years
- Rolling mechanical parts (Sheaves, cables, rolls, etc.): 1 year
- Hydraulic Hoses, Electrical Components: 1 year

OPTIONS

OPTIONAL 100,000 LB. STEEL EXTENDABLE HYDRAULIC TAIL (STINGER TAIL).

- Additional axles (Self-tacking or directional)
- Scale system
- Telescoping lift cylinder
- Hydraulic Reserve Increase
- Hydraulic bio-oil
- Automatic lubricating system
- Transmission or engine system programming
- Tarp crank system
- Stinger tail
- Removable stoppers and sleeve inserts
- 5 1/2" side rollers
- Wear plates on frame, full length 1/2" x 3"
- Additional 3/4" quick plug-in valves (without tubing) for additional accessories
- Skid-resistant fenders made of galvanized stainless steel or polyethylene for tandem axles
- Additional support between rollers
- Structural assembly to install a pup trailer hitch with a hydraulic connector or pup carrier
- Pup trailer coupling. Complete installation (frame must be prepared accordingly)
- Pneumatic lock
- Assortment of pumps and PTO for manual or automatic transmission
- Crosby or Gunnabo hook
- LED Work lights
- Camera located behind the lifting system
- Alarm (light/ sound) upon roll-off lifting
- Aluminum or steel toolbox with support brackets
- Auto-retract rear bumper
- Rear stabilizer
- Shovel and support bracket
- Extinguisher and support bracket
- Industrial broom with mounting bracket
- Selection of colours (to be determined)
- Extended warranty

PHOTOS





DRAWINGS

DRC-6025-AF - ABOVE FRAME LIFT CYLINDERS

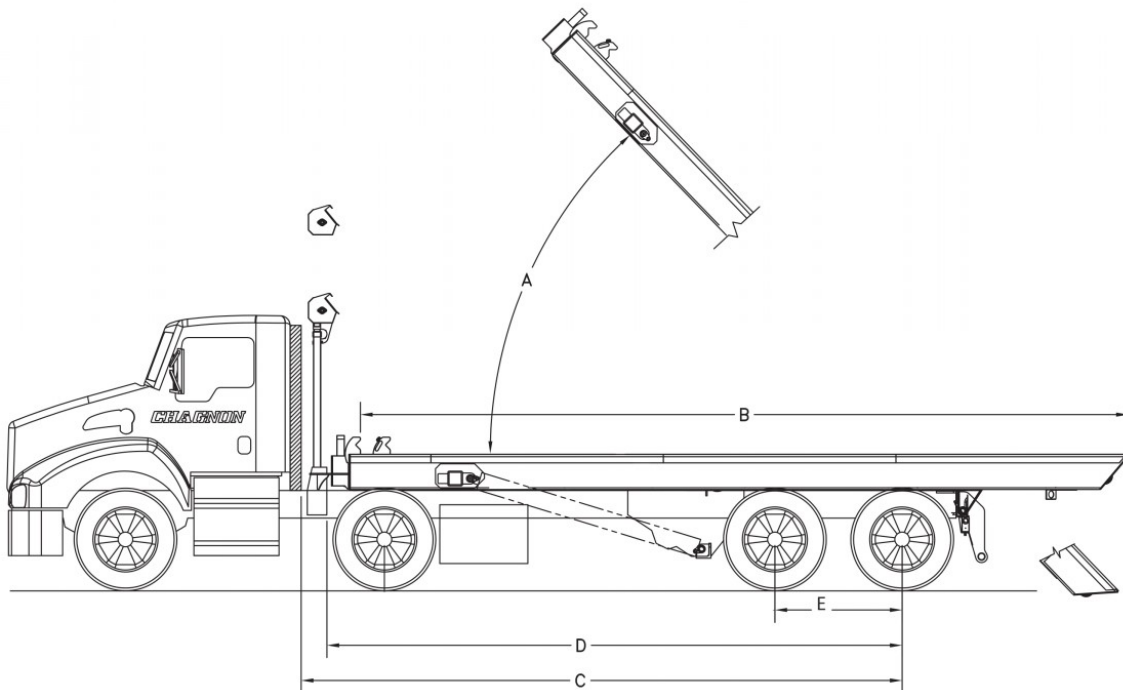

	MODEL	DRC-6025-AF
A	Dump angle	49°

B	Hoist length	314 ½"
C	Clearance from the rear cabin to the last axle, including space for the tarping system	232"
D	Clearance from the rear cabin to the last axle, excluding space for the tarping system	220"
E	Spread	52"